

SUBMITTAL DATA SHEET

No-Lead
Angle Sillcock with Vacuum Breaker – 72015VB

FNPT X MGHT



A.Y. McDonald Mfg. Co. No-Lead Low Pressure Valves are constructed from heavy duty no-lead brass and are recommended for residential and commercial applications and positive shut-off with various inlet configurations.

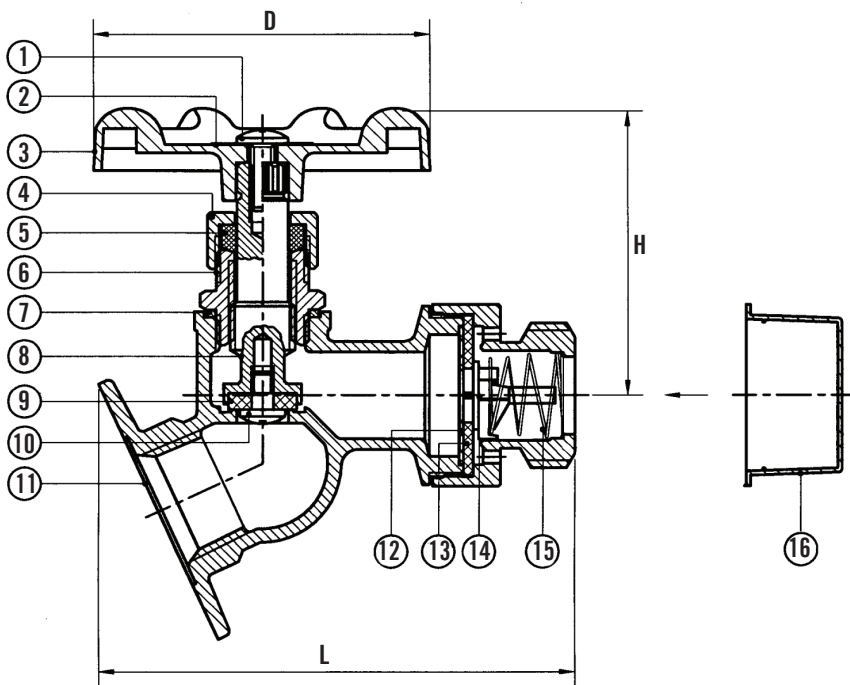

Dimensions

Part No.	Size	D	H	L
5424-037	1/2" FNPT x 3/4" MGHT	2.44	2.20	3.54
5424-038	3/4" FNPT x 3/4" MGHT	2.44	2.20	3.58

Materials

No.	Part	Material
1	Handle Bolt	Steel
2	Name Plate	Aluminium
3	Handle	Zinc
4	Packing Nut	No-Lead Brass
5	Gland Packing	Graphite
6	Bonnet	No-Lead Brass
7	Packing	Formocon
8	Stem	No-Lead Brass
9	Seat Packing	Rubber
10	Seat Screw	No-Lead Brass
11	Body	No-Lead Brass
12	Washer	No-Lead Brass
13	Seat Packing	Rubber
14	Spring Seat	Formocon
15	Spring	Stainless-Steel
16	Thread Protector	

SUBMITTAL INFORMATION

- 125 WOG
- Available Sizes: 1/2" and 3/4"
- 2" Flange Diameter
- Vacuum Breaker is Non-removable
- Rubber Coated Oval Handle
- NSF 61-8
- NSF/ANSI 372

NO-LEAD: The weighted average of the wetted surface of this no-lead product contacted by consumable water contains less than one quarter of one percent (0.25%) lead.



A.Y. McDonald Mfg. Co.
4800 Chavenelle Rd
Dubuque, IA 52002

Toll Free: 1-800-292-2737
sales@aymcdonald.com
aymcdonald.com

A.Y. McDonald considers the information on this assembly drawing correct when published. Item and option availability, including specifications, are subject to change without notice.

Submitted by: