

SUBMITTAL DATA SHEET

No-Lead Standard Port Ball Valve with Lever Handle – 72030MPL

PEX x MNPT

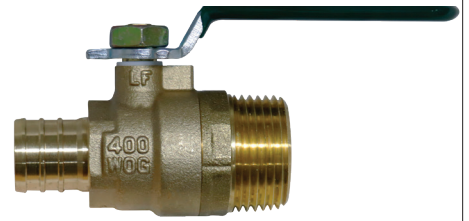

A.Y. McDonald Mfg. Co. No-Lead Ball Valves are constructed of heavy duty no-lead forged brass and can be used in commercial, industrial and residential applications. This is a standard port valve with excellent flow characteristics.

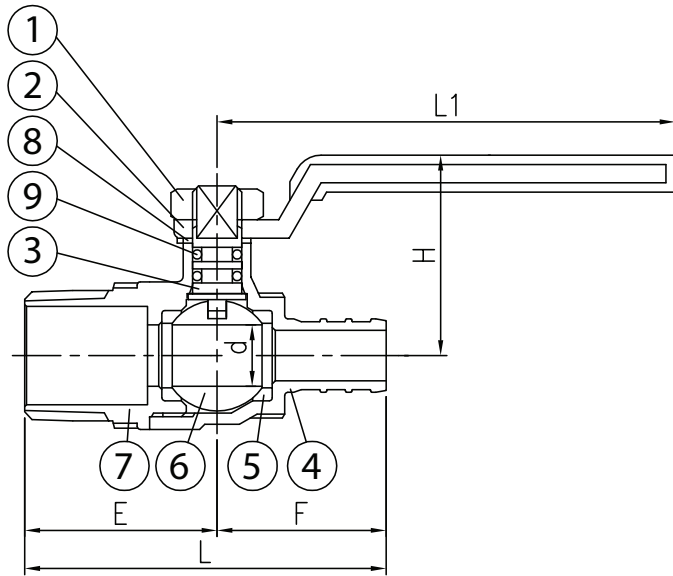

Materials

No.	Part	Material
1	Nut	Steel
2	Handle	Steel
3	Stem	No-Lead Brass
4	Body	No-Lead Brass (C46400)
5	Ball Disc Packing	Teflon
6	Ball Disc	No-Lead Brass
7	End Plug	No-Lead Brass
8	Washer	Teflon
9	O-Ring	NBR

Dimensions

Size	L	H	d	A	E	F
3/4"	2.40"	1.34"	0.50"	2.95"	1.30"	1.10"

SUBMITTAL INFORMATION

- Available Size: 3/4"
- 400 WOG
- 150WSP
- Pex end conforms to ASTM F1807
- Blowout proof stem

NO-LEAD: The weighted average of the wetted surface of this no-lead product contacted by consumable water contains less than one quarter of one percent (0.25%) lead.



A.Y. McDonald Mfg. Co.
4800 Chavenelle Rd
Dubuque, IA 52002

Toll Free: 1-800-292-2737
sales@aymcdonald.com
aymcdonald.com

A.Y. McDonald considers the information on this assembly drawing correct when published. Item and option availability, including specifications, are subject to change without notice.

Submitted by: