

# SUBMITTAL DATA SHEET

861 1 1/4" Series Key

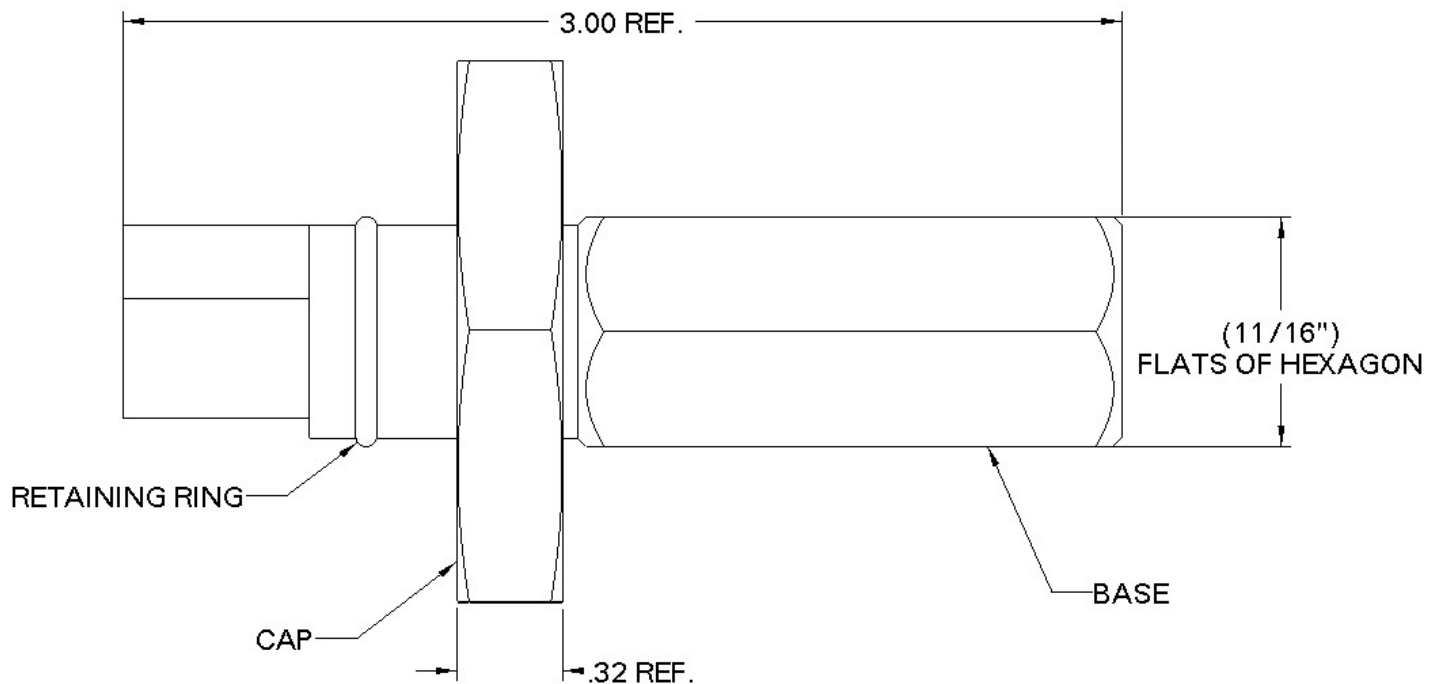

## SUBMITTAL INFORMATION

- Base made from 4140 pre-hardened steel or equivalent with zinc clear plating
- Cap made from 303L stainless steel or equivalent
- Retaining ring made from 14 gage phosphor bronze wire, spring temper ATM B159, copper alloy UNS C51000



**A.Y. McDonald Mfg. Co.**  
4800 Chavenelle Rd  
Dubuque, IA 52002

**Toll Free:** 1-800-292-2737  
sales@aymcdonald.com  
[aymcdonald.com](http://aymcdonald.com)

A.Y. McDonald considers the information on this assembly drawing correct when published. Item and option availability, including specifications, are subject to change without notice.

**Submitted by:**