

# SUBMITTAL DATA SHEET

NL Service Fitting – 74760F

FNPT x FNPT x FNPT

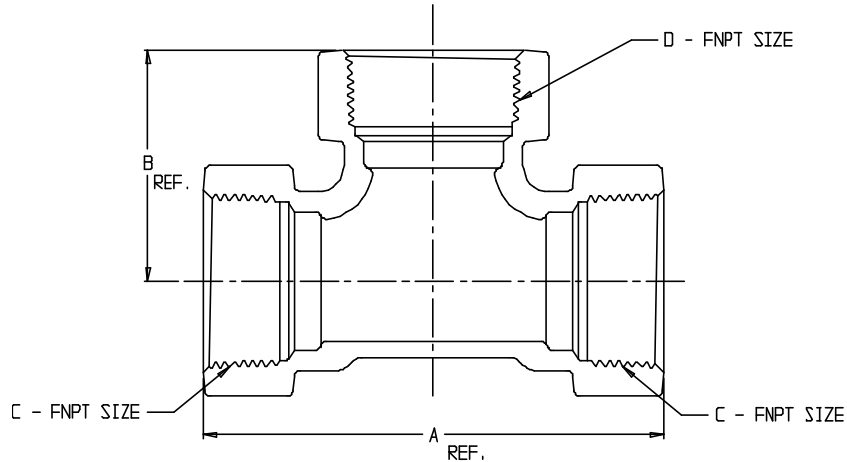

MODEL NO.	SIZE	A	B	C	D
74760F	3/4	3.22	1.61	3/4	3/4
74760F	1	3.65	1.81	1	1
74760F	1 1/4	4.35	2.18	1 1/4	1 1/4
74760F	1 1/2 X 3/4	4.63	2.06	1 1/2	3/4
74760F	1 1/2 X 1	4.63	2.06	1 1/2	1
74760F	1 1/2	5.50	2.75	1 1/2	1 1/2
74760F	2 x 3/4	4.12	2.34	2	3/4
74760F	2 x 1	4.12	2.34	2	1
74760F	2	5.13	2.57	2	2

## SUBMITTAL INFORMATION

- Manufactured in compliance with ANSI/AWWA C800 (latest revision)
- Brass components in contact with potable water conform to ASTM B584, UNS C89833 (latest revision) and identified with “NL”
- Certified to NSF/ANSI 61 and NSF/ANSI 372
- Brass components not in contact with potable water conform to ASTM B62 and ASTM B584, UNS C83600 -85-5-5-5 (latest revision)
- Large wrench flats provided for proper installation



**A.Y. McDonald Mfg. Co.**  
4800 Chavenelle Rd  
Dubuque, IA 52002

**Toll Free: 1-800-292-2737**  
sales@aymcdonald.com  
[aymcdonald.com](http://aymcdonald.com)

A.Y. McDonald considers the information on this assembly drawing correct when published. Item and option availability, including specifications, are subject to change without notice.

**Submitted by:**