

SUBMITTAL DATA SHEET

Two Piece Brass Saddle - 3808

C900 PVC x FNPT

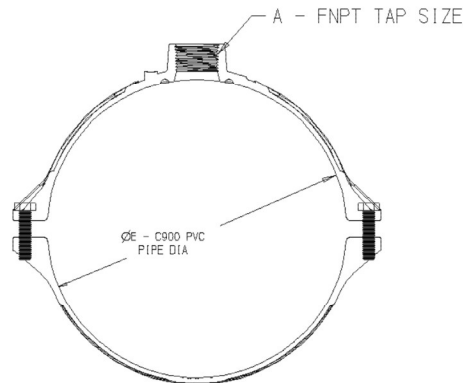
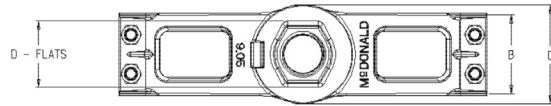

MODEL	SIZE	A	B	C	D	E
3808	4 X 1	1	2.50	3.96	2.92	4.80
3808	4 X 1 1/2	1 1/2	2.50	3.96	2.92	4.80
3808	4 X 2	2	2.50	3.96	2.92	4.80
3808	6 X 1	1	2.50	3.96	2.92	6.90
3808	6 X 1 1/2	1 1/2	2.50	3.96	2.92	6.90
3808	6 X 2	2	2.50	3.96	2.92	6.90
3808	8 X 1	1	2.50	3.00	1.69	9.05
3808	8 X 1 1/2	1 1/2	2.50	3.96	3.10	9.05
3808	8 X 2	2	2.50	3.96	3.10	9.05

SUBMITTAL INFORMATION

- Manufactured in compliance with ANSI/AWWA C800 (latest revision)
- Brass components conform to ASTM B62 and ASTM B584, UNS C83600 -85-5-5-5 (latest revision)
- Certified to NSF/ANSI 61
- 316 SS bolts
- EPDM o-ring
- Pipe and tap size, and thread type identified on saddle
- Outlet boss with large wrench flats



A.Y. McDonald Mfg. CO.
4800 Chavenelle Rd
Dubuque, IA 52002

Toll Free: 1-800-292-2737
sales@aymcdonald.com
aymcdonald.com

A.Y. McDonald considers the information on this assembly drawing correct when published. Item and option availability, including specifications, are subject to change without notice.

Submitted by: