

SUBMITTAL DATA SHEET

NL Service Fitting – 74742F

Special Purpose x FNPT

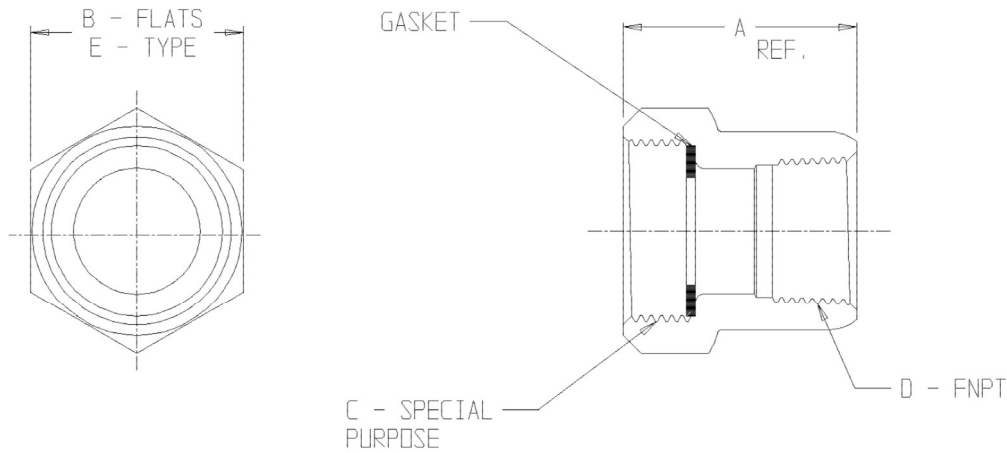

MODEL	SIZE	A	B	C	D	E
74742F	1/2 X 3/4	1.72	1.38	1/2	3/4	HEX
74742F	5/8 X 3/4	1.60	1.31	5/8	3/4	HEX
74742F	5/8 X 1	1.68	1.32	5/8	1	OCT
74742F	3/4	1.63	1.48	3/4	3/4	HEX
74742F	3/4 X 1	1.60	1.50	3/4	1	OCT
74742F	1	1.75	1.75	1	1	HEX

SUBMITTAL INFORMATION

- Manufactured in compliance with ANSI/AWWA C800 (latest revision)
- Brass components in contact with potable water conform to ASTM B584, UNS C89833 (latest revision) and identified with “NL”
- Certified to NSF/ANSI 61 and NSF/ANSI 372
- Brass components not in contact with potable water conform to ASTM B62 and ASTM B584, UNS C83600 -85-5-5-5 (latest revision)
- Large wrench flats provided for proper installation



A.Y. McDonald Mfg. Co.
 4800 Chavenelle Rd
 Dubuque, IA 52002

Toll Free: 1-800-292-2737
sales@aymcdonald.com
aymcdonald.com

A.Y. McDonald considers the information on this assembly drawing correct when published. Item and option availability, including specifications, are subject to change without notice.

Submitted by: